

GENERAL NOTES:

NO.	DESCRIPTION	DATE:

ALUK[®]

IMPERIAL PARK
 CELTIC WAY
 NEWPORT
 GWENT
 NP10 8BE
 TEL: 01633 810440
 FAX: 01633 816004
 www.aluk.co.uk

ALL INFORMATION CONTAINED IN THIS DRAWING IS THE EXCLUSIVE INTELLECTUAL PROPERTY OF ALUK (GB) LTD. IT MAY ONLY BE USED FOR THE PURPOSE TO WHICH IT HAS BEEN SUPPLIED AND MUST NOT BE REPRODUCED, STORED OR DISSEMINATED TO THIRD PARTIES IN ANY WAY OR FORM WITHOUT THE EXPRESS WRITTEN PERMISSION OF ALUK (GB) LTD. THE ALUK POLICY OF CONTINUOUS IMPROVEMENT DETERMINES THE RIGHT TO MAKE MODIFICATIONS WITHOUT PRIOR WARNING.

PROJECT NAME & ADDRESS:

DRAWN BY:

DATE:

TEMPLATE ISSUE :	DATE (DD/MM/YYYY):
3	21/05/2013

SHEET: 1

SCALE:

DIMS: MM
 UNLESS OTHERWISE STATED



ALL DOCUMENTATION RELATIVE TO:
 BRITISH STANDARDS: BS 8888:2006

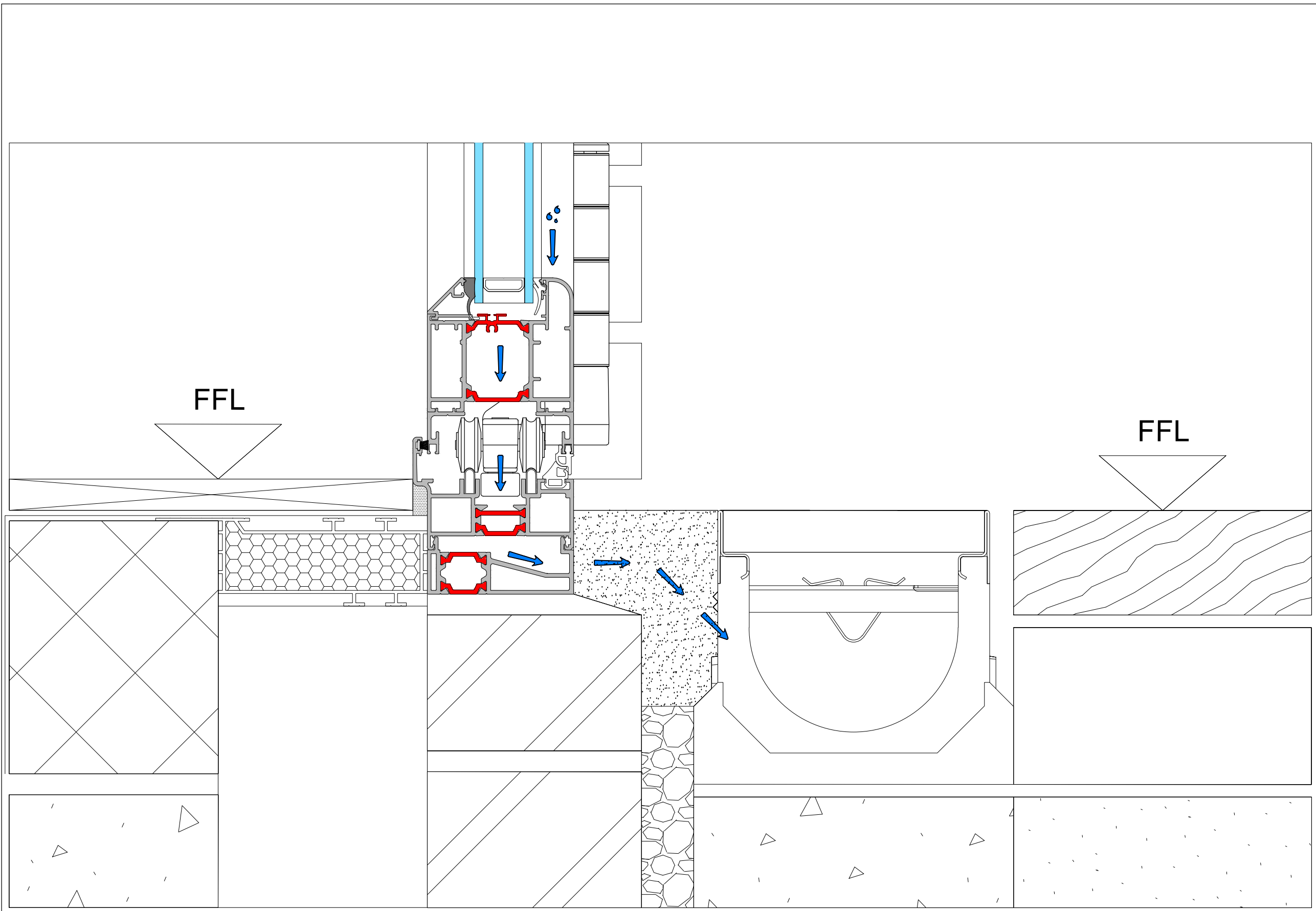

GENERAL NOTES:

NO.	DESCRIPTION	DATE:

ALUK[®]

IMPERIAL PARK
 CELTIC WAY
 NEWPORT
 GWENT
 NP10 8BE

TEL: 01633 810440
 FAX: 01633 816004
 www.aluk.co.uk

ALL INFORMATION CONTAINED IN THIS DRAWING IS THE EXCLUSIVE INTELLECTUAL PROPERTY OF ALUK (GB) LTD. IT MAY ONLY BE USED FOR THE PURPOSE TO WHICH IT HAS BEEN SUPPLIED AND MUST NOT BE REPRODUCED, STORED OR DISSEMINATED TO THIRD PARTIES IN ANY WAY OR FORM WITHOUT THE EXPRESS WRITTEN PERMISSION OF ALUK (GB) LTD. THE ALUK POLICY OF CONTINUOUS IMPROVEMENT DETERMINES THE RIGHT TO MAKE MODIFICATIONS WITHOUT PRIOR WARNING.

PROJECT NAME & ADDRESS:

DRAWN BY:

DATE:

TEMPLATE ISSUE : DATE (DD/MM/YYYY):

3 21/05/2013

SHEET: 1

SCALE:

DIMS: MM
 UNLESS OTHERWISE STATED

ANGLE:

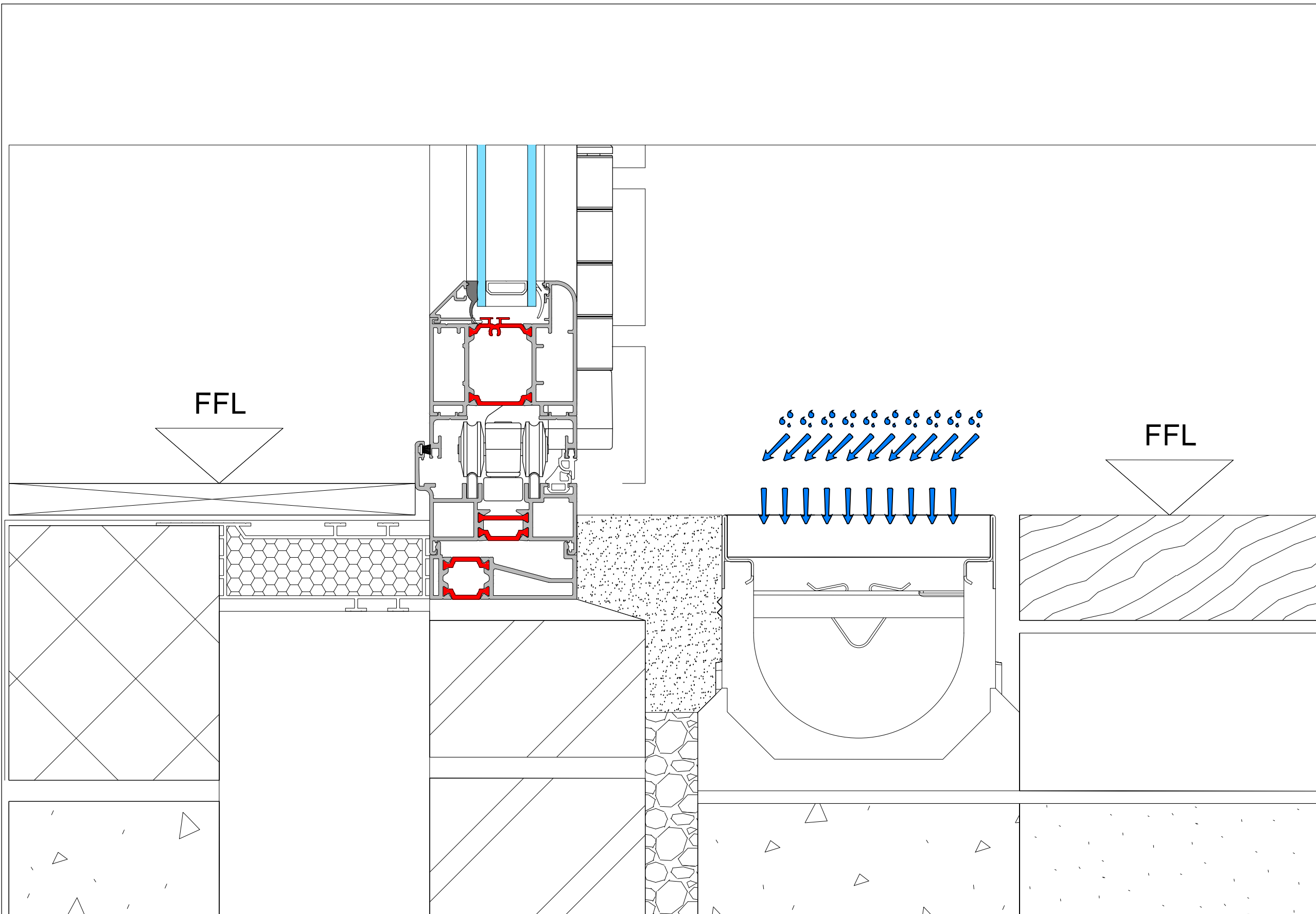

GENERAL NOTES:

NO.	DESCRIPTION	DATE:
-----	-------------	-------

ALUK[®]

IMPERIAL PARK
 CELTIC WAY
 NEWPORT
 GWENT
 NP10 8BE

TEL: 01633 810440
 FAX: 01633 816004
 www.aluk.co.uk

ALL INFORMATION CONTAINED IN THIS DRAWING IS THE EXCLUSIVE INTELLECTUAL PROPERTY OF ALUK (GB) LTD. IT MAY ONLY BE USED FOR THE PURPOSE TO WHICH IT HAS BEEN SUPPLIED AND MUST NOT BE REPRODUCED, STORED OR DISSEMINATED TO THIRD PARTIES IN ANY WAY OR FORM WITHOUT THE EXPRESS WRITTEN PERMISSION OF ALUK (GB) LTD. THE ALUK POLICY OF CONTINUOUS IMPROVEMENT DETERMINES THE RIGHT TO MAKE MODIFICATIONS WITHOUT PRIOR WARNING.

PROJECT NAME & ADDRESS:

DRAWN BY:

DATE:

TEMPLATE ISSUE : DATE (DD/MM/YYYY):

3	21/05/2013
---	------------

SHEET: 1

SCALE:

DIMS: MM
 UNLESS OTHERWISE STATED

ANGLE:

ALL DOCUMENTATION RELATIVE TO:
 BRITISH STANDARDS:BS 8888:2006